

Exhibition Counter Stand Set Up Instruction

SKU: PECDUOVYL

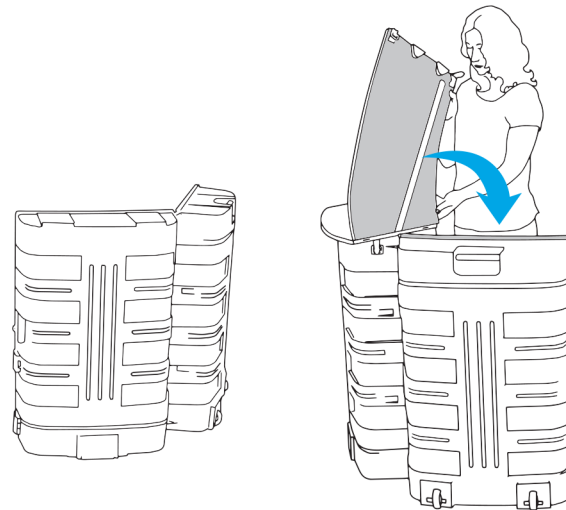

- A. 2x Shipping Case
- B. Shelves & Storage Pouch
- C. Countertop & Storage Pouch
- D. PVC Kick Plate
- E. Hook and Loop Strip
- F. Graphic Carrying Tube



1. Stand shipping case upright, unlock the 4 clips and open the case. Lift up countertop latches. Align underside groove with shipping case edge and rest in place.

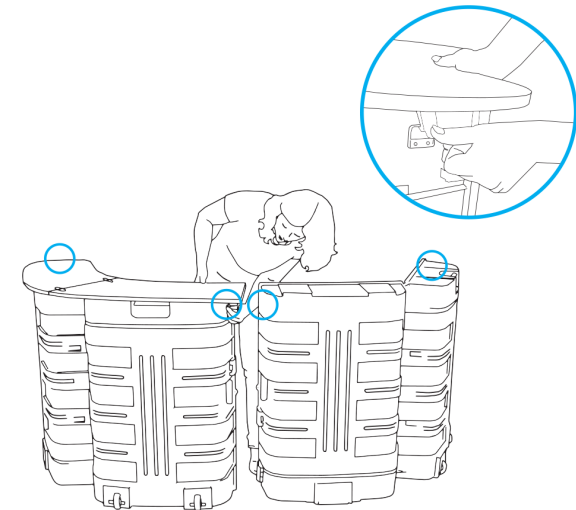

2. Secure 4 underside latches to hooks attached to the side of the case. Repeat step 1 & 2 on the other side.

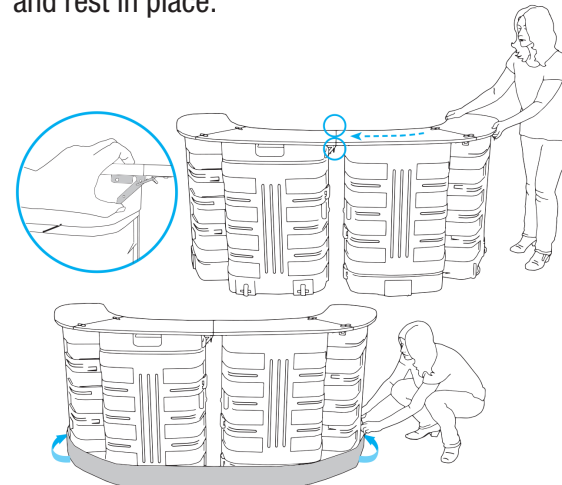

3. Move 2 assembled cases next to each other and join them by locking the latches underneath the countertops. Wrap PVC kickplate around the bottom to cover wheels. Attach the hook and loop strips on the ends of the kickplate to the corresponding pieces inside the case.

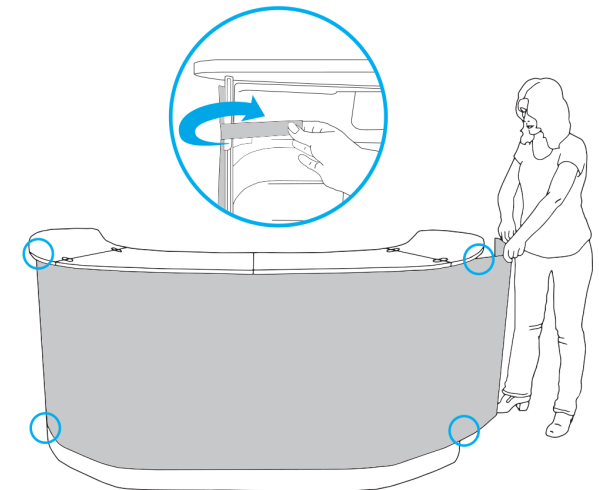

4. Remove the protective paper on the adhesive backing of 4 hook and loop strips and apply to the back side of the graphics. Be sure the attached strips match with corresponding pieces. Insert the graphic panel inside the kickplate and attach the hook and loop strips to the case. Insert shelves at the designated slots inside the case.