

Smart Touch Lamp Speaker

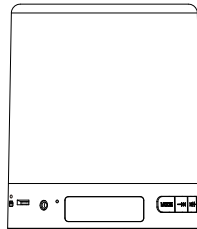

Packing list



Speaker



User Manual



3.5mm Audio Cable

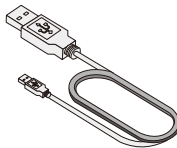

USB Cable

Introduction

Smart touch lamp speaker is a product which integrates the touchable lamp and the bluetooth speaker. The touchable lamp can be easily switched on/off and adjusted into different brightness level by a hand touch at the top of the product centre. The Bluetooth speaker is a smart device which integrates audio player(Bluetooth mode, SD mode, Line In mode), FM player and clock function. Please check detail operations in each function description in following paragraph. Please refer to the Operational Instruction.

Specifications

Product Name: Smart touch lamp speaker
 Power Input: Micro USB, DC5V \equiv 1000mA
 Battery Capacity: 3.7V/2000mA
 Charging Time: 2.5-4hours
 Speaker Specification: 2.5Inch, 4ohm/5W
 Frequency Response: 70Hz-20KHz
 Distortion: \leq 0.5%
 Signal to Noise Ratio: \geq 65db
 Material: ABS/Silica-gel
 Music Playing Time: 15 hours at volume level 15.
 Lighting Time: 15 hours at the lowest brightness.

Button Functions

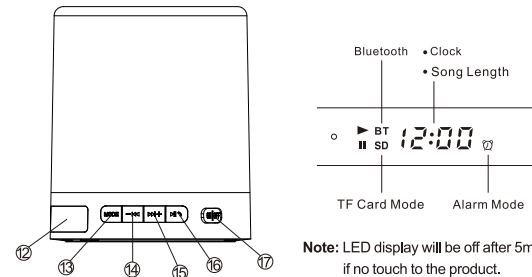
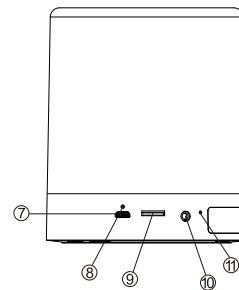
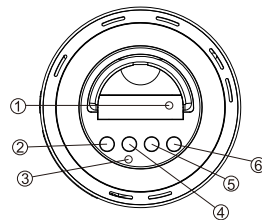

Button/Indicator List

- ① Power Switch: it's used to cut off the power supply under safety purpose in delivery. The product can't get power supply when this switch is off.
- ② Alarm Set: Enter alarm set mode.
- ③ Sleep Indicator: It will light when sleep mode is turned on.
- ④ Sleep: The turn on/off automatic sleep mode.
- ⑤ Alarm On: Turn on/off the alarm.
- ⑥ Clock Set: Enter clock set mode.
- ⑦ Charging Port: Micro USB port for power input.
- ⑧ Charging Indicator: To show whether battery's charging?
- ⑨ TF Port: Port to insert TF card.
- ⑩ Line In: 3.5mm port to connect line in signal.
- ⑪ Micro Phone: Micro phone for hand free call in bluetooth mode.
- ⑫ LED Display
- ⑬ Mode: Switch speaker in different modes (bluetooth, TF, line in, FM tuner).
- ⑭ \lll : Play back/volume down/number down.
- ⑮ \ggg : Play forward/volume up/number up.
- ⑯ II : Play/pause/pick up
- ⑰ ON/OFF: Switch to active/sleep mode.

Operational Instruction

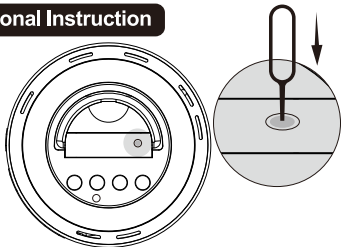

Power On and Charging

Caution: Turn on ① **power switch** before the first use by pressing with a pin, this is the switch of the product power supply, normally it's off before handing over, the product can not work if the switch is off. Normally, the switch is off for safety measures during delivery.

Charge the speaker with the provided USB cable which is compatible with any cell phone charger.(Note: the output voltage is 5V, and output current should be 1000mA and above).

The ⑧ **charging indicator** is red while charging and goes off when the speaker is fully charged.

ON/OFF

Slide the ⑰ **ON/OFF** to switch the speaker into the Active or the Sleep mode. In Active mode, all the function is available. In Sleep mode, only alarm/clock is running and the battery consumes at the lowest speed.

Note: Don't slide the ON/OFF too quickly, wait at least 2s after each slide.

Automatic Sleep Mode

Press the ④ **sleep** button to choose 10min,20min,30min as countdown. When time is choosed, countdown will start after 3 seconds and turn on ③ **blue indicator**.

Clock Setting

Long press ⑥ **Clock Set** button to enter the Clock Setting Mode, the hour number displayed will flash. Press ⑮ **▶|▶** to switch hours or minutes setting. Press ⑮ **▶|▶** + ⑭ **←|←** to set displayed numbers. Short press ⑥ **Clock Set** to set and quit clock setting.

Alarm Setting

Long press ② **Alarm Setting** button to enter the Alarm Setting Mode, the hour number displayed will flash. Press ⑮ **▶|▶** to switch hour or minutes setting. Press ⑮ **▶|▶** + ⑭ **←|←** to set displayed numbers. Short press ② **Alarm Setting** to set and quit alarm setting, the alarm will be effective then. ⑤ **Alarm On** button is to simply turn on and off the alarm.

Speaker Mode Selection

Press ⑬ **Mode** once after several times to switch the speaker into different modes: Bluetooth mode, TF card music mode, line in mode, FM tuner mode, standby mode. If there are no TF the card inserted in TF port, the mode cycle will pass TF card music mode.

Bluetooth Mode

Press ⑬ **Mode** to set the Bluetooth mode, the speaker will be ready for paring, and the screen displays "blue". Open the Bluetooth setting on your Bluetooth device and search for the speaker, click "Lamp Speaker" to choose and connect, and the speaker will say show " bluetooth is connected" when connection succeed.

Volume Up: long press ⑮ **▶|▶** +
Volume Down: long press ⑭ **←|←**
Last Song: short press ⑭ **←|←**
Next Song : short press ⑮ **▶|▶** +
Play/Pause: short press ⑮ **▶|▶** |

Note:

- (1) When the same bluetooth device is used again, the speaker will connect it automatically. New Bluetooth connection can not be built if the last connection is not cut off.
- (2) If the Bluetooth connection can not be built successfully, please remove the bluetooth name in your phone and reboot the speaker by turning on and by turning off ① **Power Switch**.

Bluetooth Hand Free Call

In bluetooth connection, the speaker will read the calling number when a call is coming in, press ⑮ **▶|▶** to pick up a hand free call. Please speak Closer to the micro phone to get better voice quality.

TF Card Music Mode

Insert a TF card with music, press Mode button to enter the "TF Card Music Mode", the speaker will automatically play music in priority of stored the date.

Volume Up: long press ⑮ **▶|▶** +
Volume Down: long press ⑭ **←|←**
Last Song: short press ⑭ **←|←**
Next Song : short press ⑮ **▶|▶** +
Play/Pause: short press ⑮ **▶|▶** |

Line In Mode

Press Mode button to enter the "Line In Mode", connect the speaker to an audio source with the 3.5mm connector.
Volume Up: ⑮ **▶|▶** + long press
Volume Down: ⑭ **←|←** long press

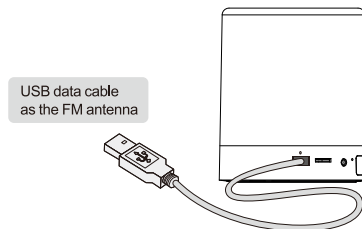

FM Tuner Mode

Press ⑬ **Mode** button to enter the FM Tuner Mode, connect USB cable to power port as FM radio antenna. Press ⑮ **▶|▶** , the speaker will automatically search and store available FM radio channel. Press ⑭ **←|←** and ⑮ **▶|▶** + to switch and play the saved channel. The speaker can save up to 99 channels.

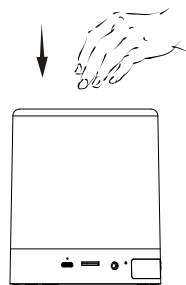

Touch Lamp

Touch the center of the top speaker grill, the lamp will switch into 3 different lighting levels after each touch.

Low Battery Alarm

If the product have low voltage, it turn into sleep mode after beeps twice. Please charge the product then. Slide the ON/OFF button to OFF and then to ON to wake up the product.