

How to use

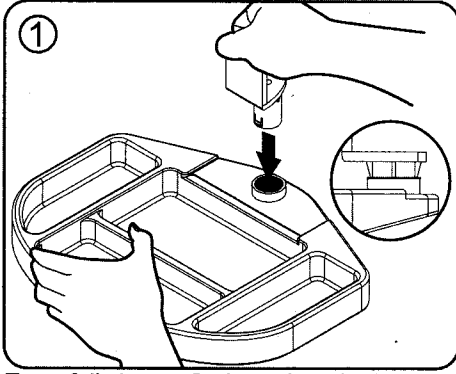

Forcefully insert C-clamp into the hole on the tray as shown in the picture

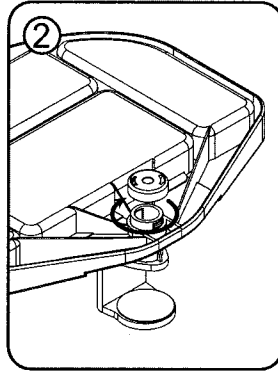

Lock the cap on the bottom of the C-clamp

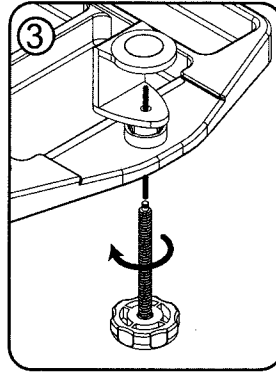

Insert screw into the C-clamp

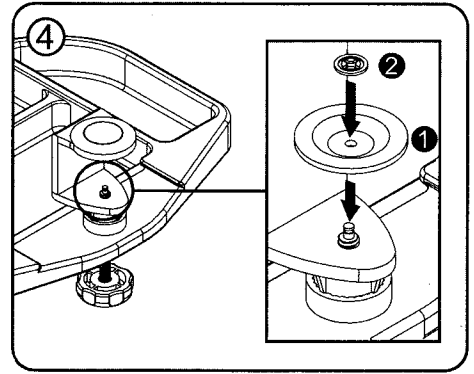

① Place the metal plate on the screw
② Place the washer over the metal plate to secure the metal plate

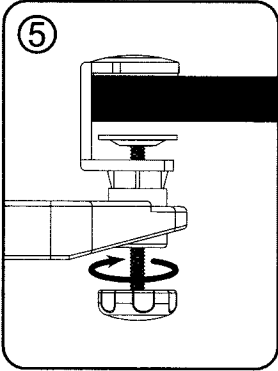

Tighten the screw to secure the tray onto a desk

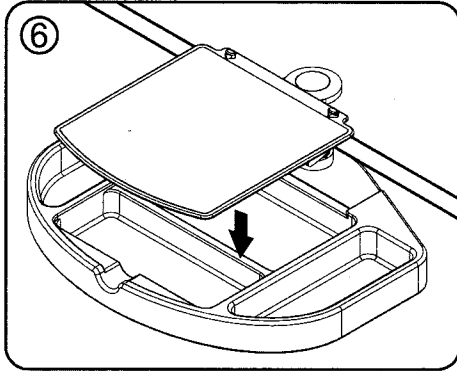

Insert mouse tray onto the center slot as shown in the picture

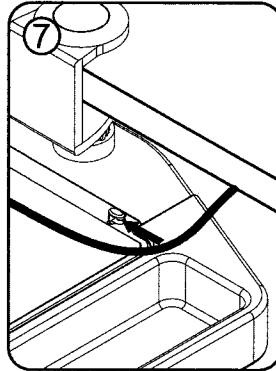

Cable manager for mouse or other devices

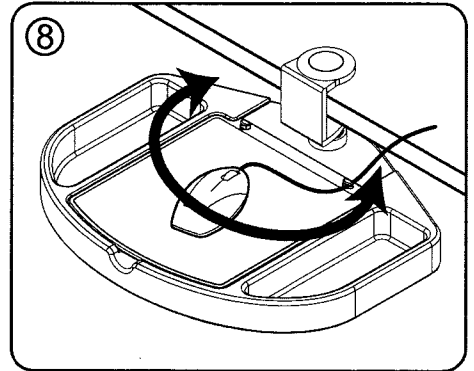

Swivel 180°

DO-1020