

# desktop reference system

## Assembly Instructions

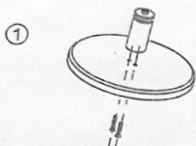

Insert 2 screws through bottom of base into short tube and tighten.

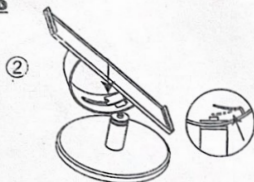

Rest support bracket with rectangular opening over connector disc. Tilt slightly backwards until support bracket aligns with groove.

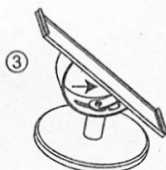

Slide forward until locking tab snaps into place.

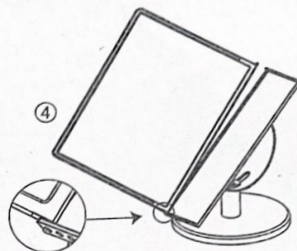

Insert sleeve peg into bottom hole of support bracket.

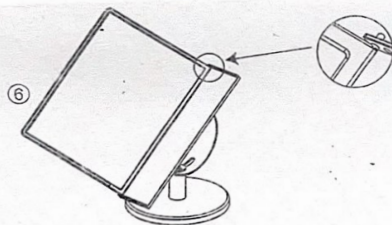
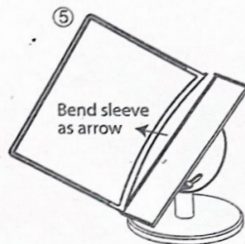

Place top peg into top hole of support bracket.

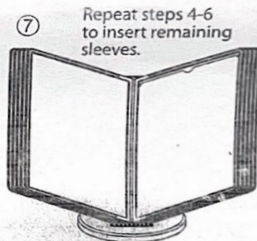

Repeat steps 4-6 to insert remaining sleeves.

Finish

## To Disassemble

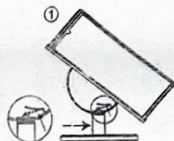

Lift up locking tab.

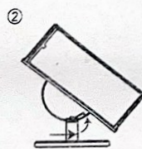

Slide support bracket backwards and tilt at an angle until rectangular opening releases from connector disc.

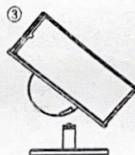

Finish

## Pivot

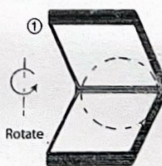

Rotate

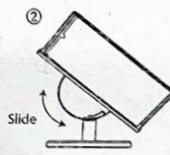

Slide

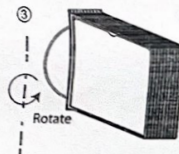

Rotate